

# Spohn Performance, Inc.

494 E Lincoln Ave Myerstown, PA 17067  
1-888-365-6064 www.spohn.net

## Part #C10-205 – Rear Trailing Arms – Del-Sphere Pivot Joints 2010+ Chevrolet Camaro / 2008+ Pontiac G8

### **USE OF THIS PRODUCT IS ACCEPTANCE OF SELLER'S DISCLAIMER OF WARRANTY!**

By their very nature, competition components are constantly pushed to their limits. While our components are designed to withstand intense race conditions, it is impossible to control the quality of installation or the varying conditions in which they are used. It is for this reason that absolutely no warranty or guarantee is either written or implied. Neither the seller or the manufacturer will be liable for any loss, damage, or injury – direct or indirect – arising from the use of or inability to determine the use of any product. Before using, the user should determine the suitability of the product for its intended use, and the user shall assume all responsibility in connection therewith. Spohn Performance, Inc. makes no guarantee as to the legality for any specific class. Spohn Performance, Inc. makes no claims, nor does it intend its products to be used in street driven vehicles. Spohn Performance, Inc. reserves the right to make changes in design or add to or improve on their product without incurring any obligation to install the same on product previously manufactured. The Buyer agrees to indemnify and hold Spohn Performance, Inc. harmless from any claim, action or demand arising out of or incident to the Buyer's installation or use of products purchased from Spohn Performance, Inc.

### **INSTRUCTIONS**

**Note:** These trailing arms were shipped jig set at OEM length.

1. Begin by jacking up the rear of the car until the rear wheels are off the ground, support car with jack stands. **Note:** It is not necessary to remove the rear wheels but it does make the installation easier.
2. Using an 18mm socket and wrench, loosen and remove the outer bolt securing the stock trailing arm to the spindle.
3. Use the 18mm socket to remove the inner bolt securing the stock trailing arm to the rear sub frame. The nut is welded to the rear sub frame and does not need to be held with a wrench.
4. Remove the factory rear trailing arm
5. Clean the inside of the rear sub frame's trailing arm mount.
6. Apply grease inside of the u-bracket where the spindle bushing will mount. Apply grease to the outside of the spindle bushings.
7. Install the Spohn rear trailing arm back in to the original position and insert both bolts
8. Repeat steps 1-7 on the other side of the vehicle
9. Torque cradle mount bolts to 74 ft/lbs. and spindle mount bolts to 30 ft/lbs.
10. Lower the vehicle back to the ground

## Del-Sphere Pivot Joint Instructions & Notes

The Del-Sphere pivot joints are slightly greased for assembly purposes. The bushings inside of the del-sphere pivot joints are made of Delrin, which is self-lubricating. We do not recommend greasing the pivot joint any further than as it is supplied as further grease will only attract and retain dirt and grit. The pivot joints are equipped with grease fittings simply because we know certain customers would want/request them no matter what we say. You'll also note we have a second tapped grease fitting hole with a threaded plug installed so you can change the position of the grease fitting on the pivot end for better access if need be depending on your mounting set-up on the vehicle.

Our Del-Sphere pivot joints are 100% rebuildable. We doubt you will ever need to rebuild them, but they certainly can be. The delrin bushings should last the life of your vehicle. What you may find is after you have a lot of miles on the pivot joints the tolerances may slightly open. It is for this reason that we made the pivot joints adjustable. By tightening the threaded end retainer you can take up any slack and make the joint as tight as it was when new, it's that simple. This also allows you to vary the torque load applied to the pivot ball. If you want a very low friction joint you can loosen the threaded end retainer, etc. When making adjustments to the threaded end retainer you will need to loosen the set screw with an allen wrench. When making your adjustment align one of the threaded retainer end's slots with the set screw and re-tighten the set screw, this locks the threaded end retainer's position in to place and keeps it locked to your setting. Use our Part# **DS34-W** adjusting tool for easy adjustments.

**What is a Del-Sphere pivot joint?** Think of the Del-Sphere pivot joint as a Delrin bushed spherical rod end. Designed and manufactured exclusively by Spohn Performance, we have taken street suspension performance to the next level. Our Del-Sphere pivot joint features a one piece forged and heat treated chrome moly housing, a heat treated and chrome plated chrome moly spherical ball, Delrin bushing races, heat treated retainer washer and snap ring, heat treated and chrome plated chrome moly threaded adjuster ring, an external grease fitting and a beautiful silver zinc plated housing finish. The delrin bushing races absorb shock and road noise so you get the quiet and smooth ride of a bushing as well as **28 degrees of rotation!**

**What is Delrin, and why did you choose to use it?** Delrin is an acetal homopolymer made by DuPont. It is characterized as having an excellent combination of physical properties that make it suitable for numerous applications. With extremely low moisture absorption and a low coefficient of friction (self-lubricating), Delrin is uniquely tailored for wear applications in high humidity or moisture environments. Delrin will maintain constant physical properties under high moisture conditions and out-perform nylon or polyurethane under these conditions. Delrin has a 10,000 psi tensile strength and a 120 Rockwell Hardness rating making it ideal for our Del-Sphere pivot joint application.

### **Replacement Parts:**

<b>Part #</b>	<b>Description</b>
DS34RH	Del-Sphere Assembly - 3/4"-16 RH x 3/4" Bore
DS34LH	Del-Sphere Assembly - 3/4"-16 LH x 3/4" Bore
DS34-Wash	Del-Sphere End Washer
DS34-W	Del-Sphere Adjustment Tool
DS34-TE	Del-Sphere Threaded Adjuster End
DS34-SR	Del-Sphere Snap Ring
DS34-Bush	Del-Sphere Delrin Bushing (2 per assembly)
DS34-Ball	Del-Sphere Spherical Ball

## Trailing Arm Replacement

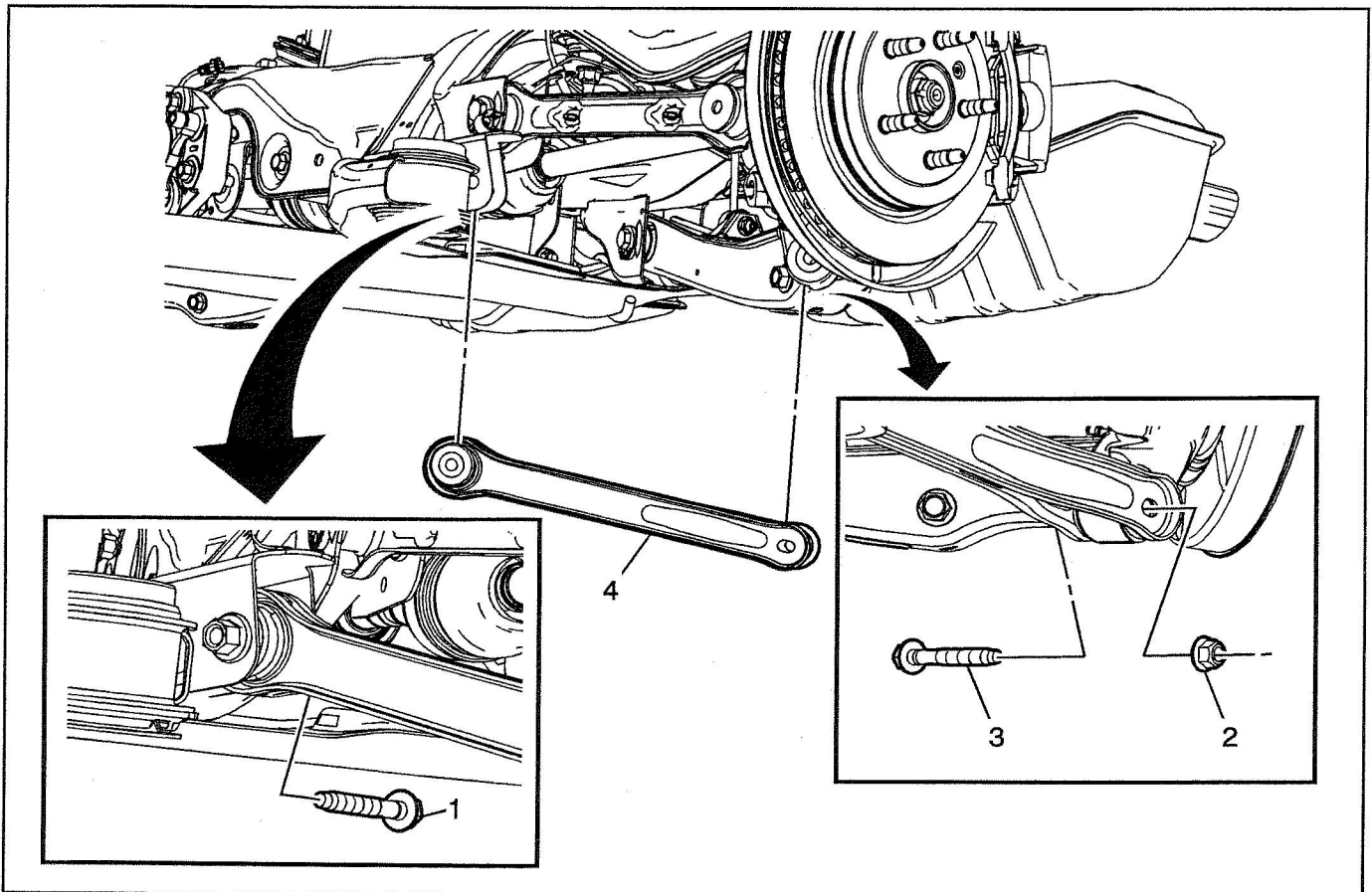

2193438

## Trailing Arm Replacement

Callout	Component Name
<b>Preliminary Procedures</b>	
1. Raise and support the vehicle. Refer to <i>Lifting and Jacking the Vehicle</i> on page 1-40.	
2. Remove the tire and wheel assembly. Refer to <i>Tire and Wheel Removal and Installation</i> on page 16-66.	
1	Rear Suspension Trailing Arm Bolt <b>Caution:</b> Refer to <i>Fastener Caution</i> on page 0-7. <b>Tighten</b> 100 N•m (74 lb ft)
2	Rear Suspension Trailing Arm Nut
3	Rear Suspension Trailing Arm Bolt <b>Tighten</b> 40 N•m (30 lb ft) plus 120 degrees
4	Rear Suspension Trailing Arm <b>Procedure</b> Check and adjust the rear wheel alignment, if needed. Refer to <i>Rear Camber Adjustment</i> on page 16-75.