

Spohn Performance, Inc.

494 E Lincoln Ave Myerstown, PA 17067
1-888-365-6064 www.spohn.net

Part #C10-201-DEL – Rear Trailing Arms - Delrin Bushings 2010+ Chevrolet Camaro / 2008+ Pontiac G8

USE OF THIS PRODUCT IS ACCEPTANCE OF SELLER'S DISCLAIMER OF WARRANTY!

By their very nature, competition components are constantly pushed to their limits. While our components are designed to withstand intense race conditions, it is impossible to control the quality of installation or the varying conditions in which they are used. It is for this reason that absolutely no warranty or guarantee is either written or implied. Neither the seller or the manufacturer will be liable for any loss, damage, or injury – direct or indirect – arising from the use of or inability to determine the use of any product. Before using, the user should determine the suitability of the product for its intended use, and the user shall assume all responsibility in connection therewith. Spohn Performance, Inc. makes no guarantee as to the legality for any specific class. Spohn Performance, Inc. makes no claims, nor does it intend its products to be used in street driven vehicles. Spohn Performance, Inc. reserves the right to make changes in design or add to or improve on their product without incurring any obligation to install the same on product previously manufactured. The Buyer agrees to indemnify and hold Spohn Performance, Inc. harmless from any claim, action or demand arising out of or incident to the Buyer's installation or use of products purchased from Spohn Performance, Inc.

INSTRUCTIONS

1. Begin by jacking up the rear of the car until the rear wheels are off the ground, support car with jack stands. **Note:** It is not necessary to remove the rear wheels but it does make the installation easier.
2. Using an 18mm socket and wrench, loosen and remove the outer bolt securing the stock trailing arm to the spindle.
3. Use the 18mm socket to remove the inner bolt securing the stock trailing arm to the rear sub frame. The nut is welded to the rear sub frame and does not need to be held with a wrench.
4. Remove the factory rear trailing arm
5. Clean the inside of the rear sub frame's trailing arm mount and then apply grease to the area the bushing will mount.
6. Apply grease on the face of the bushing on both ends. Apply grease inside of the u-bracket where the spindle bushing will mount. Apply grease to the outside of the spindle bushings.
7. Install the Spohn rear trailing arm back in to the original position and insert both bolts
8. Repeat steps 1-7 on the other side of the vehicle
9. Torque cradle mount bolts to 74 ft/lbs. and spindle mount bolts to 30 ft/lbs.
10. Lower the vehicle back to the ground
11. Grease both grease fittings approximately 3-4 pumps or until you see the bushings starting to bulge. It is recommended to grease the bushings with the vehicle lowered and the suspension loaded. Do not over grease the bushings! Over greasing the bushings will cause the bushings to mushroom and blow out from the excessive hydraulic pressure. Use synthetic silicone grease (available from Spohn Performance – Part #902).

Trailing Arm Replacement

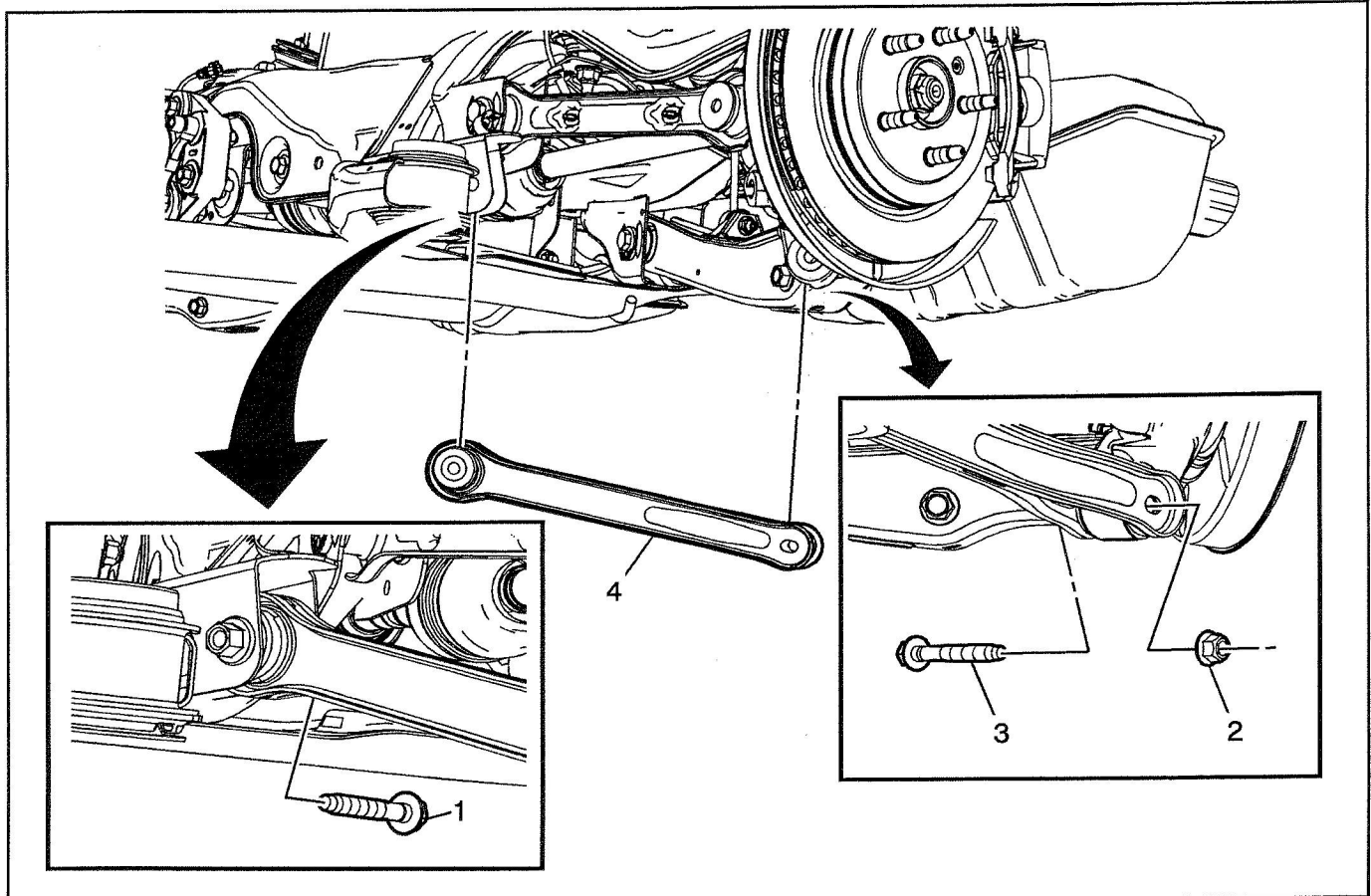

2193438

Trailing Arm Replacement

Callout	Component Name
Preliminary Procedures	
1. Raise and support the vehicle. Refer to <i>Lifting and Jacking the Vehicle</i> on page 1-40. 2. Remove the tire and wheel assembly. Refer to <i>Tire and Wheel Removal and Installation</i> on page 16-66.	
1	Rear Suspension Trailing Arm Bolt Caution: Refer to <i>Fastener Caution</i> on page 0-7. Tighten 100 N•m (74 lb ft)
2	Rear Suspension Trailing Arm Nut
3	Rear Suspension Trailing Arm Bolt Tighten 40 N•m (30 lb ft) plus 120 degrees
4	Rear Suspension Trailing Arm Procedure Check and adjust the rear wheel alignment, if needed. Refer to <i>Rear Camber Adjustment</i> on page 16-75.